



4.5" Dual Switch Pushplate

In or Out... we make it Easy!

Description

This pushplate is designed to fit neatly into standard single or double-gang electrical boxes. The faceplates are made of 1/16" thick stainless steel for durable use. The pushplate may be hard wired to access system directly, door operator or connected to one of RCI's radio-controlled transmitters.

Related Optional Accessory

Radio Controlled Transmitter and Receivers

Installation Instructions

1. Remove the two Phillips head screws from the faceplate of the pushplate.
2. Wire the switches of the pushplates to the door controllers or radio-controlled transmitters using the appropriate contacts.
3. Fasten the disassembled pushplate to the single or double-gang electrical box (by others) using the enclosed #6 screws.
4. Reattach the faceplate to the mounted backplate assembly.
5. Test the pushplate for proper activation.

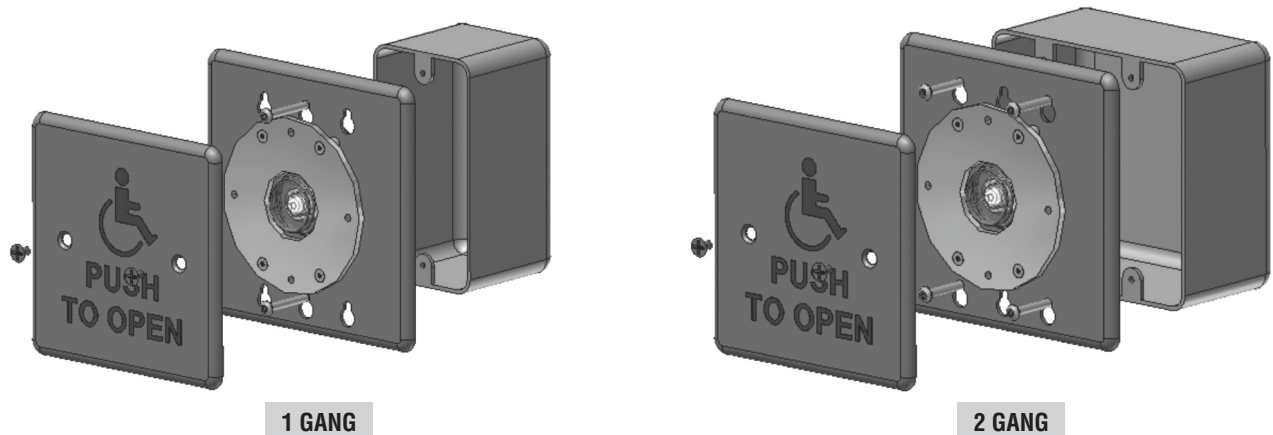

Pushplate Cleaning

The pushplates are constructed with durable stainless steel and painted with scuff-resistant coatings. To clean the plates, use only a damp, non-abrasive cloth. Repeated cleaning with harsh solvents or abrasive materials may cause deterioration of the coating. Please make the end-user aware of this procedure.

Note: Please deliver all installation instructions and End User Guides to the end-user upon completion of the installation.