



3 Series Grade 1 Electrified Commercial Cylindrical Lock Sets

In or Out... we make it Easy!®

3 Series Grade 1 Electrified Commercial Cylindrical Lock Sets

Latch:

Backset: 2-3/4" standard
Throw: 9/16"



Shown with American Lever (standard)



Ask about our selection of
Current Transfers and other
complimentary products

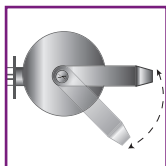

"Clutch" disengages outside lever allowing it to turn freely without opening the latch

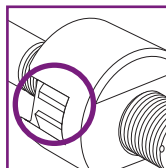

Cast stainless steel retractor with bronze roller bearings for ultra-strength, smooth operation, and long life

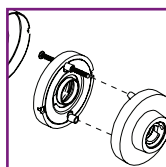

Thru-bolting ensures vibration-proof mounting and prevents lock chassis rotations

Features

- When locked, the "clutch" disengages outside lever. This reduces the torque applied to the outside lever, preventing vandalism
- Cast stainless steel retractor with bronze roller bearings
- Thru-bolting with #10 epoxy coated bolts
- Lever set withstands torque of 1800 inch-pounds. Over twice ANSI/BHMA test value
- Tested to over four million cycles
- Ultra high strength springs eliminate lever droop.
- Fits doors ranging in thickness from 1-5/8" to 1-7/8". No spacers or special tools required
- Conventional "C" 6-pin Cylinder standard. Interchangeable (IC) Cores optional*
- 100% continuous duty cycle (bridge rectifier supplied)
- Voltage: 12 or 24VDC
- Fail Locked/Unlocked
- Non-handed
- Satin Chrome Plated (26D) standard

3 Series BHMA Grade 1 Electrified Commercial Cylindrical Lock Sets

Designed for use in applications where durability is the deciding factor.

The lever set has a unique "clutch" mechanism that radically reduces the wear and abuse experienced with typical cylindrical lever sets.

When locked, the lever disengages from the retractor and other interior mechanisms of the lock. The lever swings freely without resistance. This reduces the amount of wear on lock components and eliminates "lever droop".

The performance and quality of RCI's 3 Series Grade 1 Electrified Cylindrical Lock Set makes it the ideal solution for high traffic commercial applications. All backed by RCI's Lifetime Mechanical Warranty.

Accessories

- Electrified Hinges
- Flex Loops
- Pin and Ball Wire Transfers

Highlights

- Unique "clutch" is unlike other lock sets wherein rigid levers are prone to failure because of excessive torque
- Grade 1 ANSI-A156.2 ; cULus 3 Hour Fire Rating
- Lifetime Mechanical Warranty
- Made in the USA

Applications

Interior or Exterior Doors for:

- Office Complexes
- Industrial Buildings
- Educational Facilities
- Commercial Centres
- Health Care
- Hotels
- Multi-family dwellings
- Government
- Public Buildings

Options

REX Request-to-Exit
BS1 2-3/8" Backset
Also available: 3-3/4", and 5" backsets
D2 2-1/4" Door Thickness
DS1 1 3/8" door spacer (26D)
DS2 1 3/8" door spacer (10B)
LC Less Cylinder
SCC Sargent Conventional Cylinder
IC Interchangeable Cores

Lever types... American (19-Standard), Crescent (29), Monaco (39), and Titan (49)

Finishes see reverse side*

* All options available by special order, minimum orders apply

Specifications

3 Series



In or Out... we make it Easy!®

Model	Description	Voltage	Amps	Ohms (Ω)	Lever Type	Function/Mode
3019-00	Lever Set	Non-Electrified			American (Standard)	Storeroom†
3119-05	Lever Set only - Electrified	12VDC	0.42	28	American (Standard)	Fail Locked
3119-08	Lever Set only - Electrified	24VDC	0.21	111	American (Standard)	Fail Locked
3319-05	Lever Set only - Electrified	12VDC	0.42	28	American (Standard)	Fail Unlocked
3319-08	Lever Set only - Electrified	24VDC	0.21	111	American (Standard)	Fail Unlocked

† Storeroom Function: Outside lever always locked, opened with key. Inside lever always unlocked

Specifications	
Backset	Standard: 2-3/4" Optional: 2-3/8" (BS1), 3-3/4", and 5"
Latch Front	Standard: 1-1/8" x 2-1/4"; Throw: 9/16" Stainless steel nose
Lever	Standard: American Lever (19) Optional: Crescent (29), Monaco (39), and Titan (49). With Interchangeable Cores (IC) use: American Lever (19I), Crescent (29I), and Titan (49I)
Rose	Standard: Thru-bolted, 3-7/16" diameter, spring loaded 2-#10 thru-bolts
Strike:	Standard: 4-7/8" ASA curved lip strike
Door thickness	Standard: 1-5/8" to 1-7/8". For 1-3/8" door, use spacer DS1 in 26D or DS2 in 10B finish Optional: 2-1/4" (D2)
Cylinder	Standard: Conventional "C" keyway, 6 pin w/ 2 keys (standard), keyed different Optional: LC: Less Cylinder SCC: Sargent Conventional Cylinder (available with American Lever Only) IC: Interchangeable Core Models for 6 or 7 pin cores (not included). <u>Accepts:</u> Marks, Marks Hi-Security™, Medeco®, Keymark™, Falcon, Schlage®, small format & Best®. IC Core Tail pieces are included.
Request to Exit Switch (REX)	Optional: SPDT, 3 amp, 125 AC, wired either normally open or normally closed
Finishes	Standard: Satin Chrome Plated (26D) Optional: Polished Chrome (26), Polished Brass (3), Brushed Brass (4), Brushed Light Bronze (10), and Brushed Dark Bronze (10B)

* All options are available by special order only. Minimum orders apply. Please allow 4 to 6 weeks for delivery

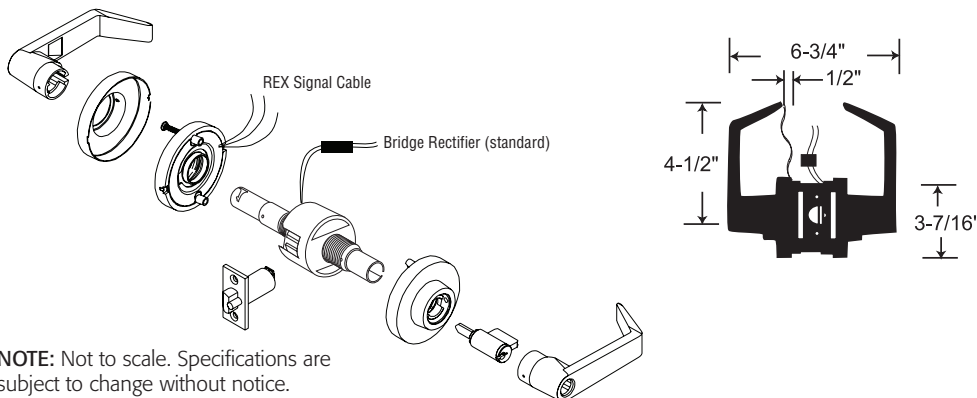

Lever Types	
American Lever standard	Crescent Lever*
Monaco Lever*	Titan Lever*

* Available by special order. Minimum orders apply

NOTE: Not to scale. Specifications are subject to change without notice.

RCI also offers a complete line of Electromagnetic Locks, Electric Strikes, Power Supplies, Switches, Key pads & Readers, Exit Devices, Systems & Door Hardware.