

3 Series Commercial Grade Cushion-Lok™ for Tempered Glass Doors With Aluminum, or Hollow Metal Frames

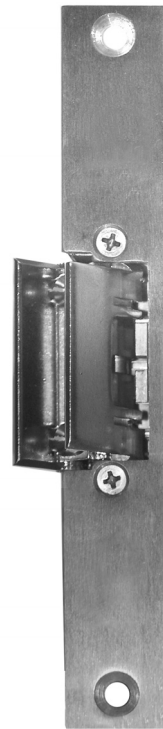

In or Out...we make it Easy!®

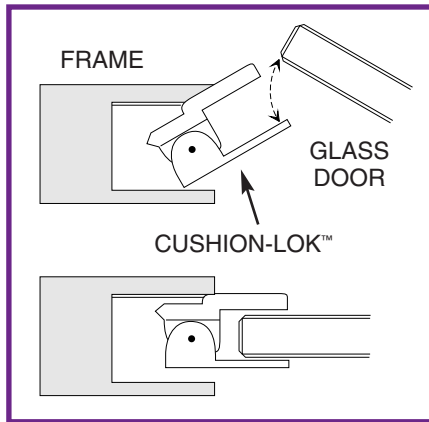

Dimensions
6-5/16" x 15/16"
(160mm x 24mm)

Features & Benefits

- Unique shock-absorbing spring loaded pivot waits in open position ensuring a gentle closure and locking of tempered glass doors
- No door preparation required for glass doors. The glass is "captured" by the Cushion-Lok™
- Adjustable for glass thickness from 11/32"–15/32" (9-12mm)
- Field Selectable 12/24 VDC
- Use on single or pairs (requires two locks) of glass doors with frames around the opening
- Shallow depth design 1-1/4" (32mm)
- All locks are "fail unlocked" by fire alarm or any power loss, ensuring life safety
- Electrical design prevents damage due to crossed wires
- Latch monitor switch option
- Stainless steel faceplate
- Non-handed

Glass Door Lock

RCI now offers a solution to the dilemma of controlling and securing tempered glass doors (without rails). Our 3371 Cushion-Lok™ securely controls a glass door while remaining unobtrusive.

The body of the lock mortises into the frame and the two-part spring loaded pivot gently cushions the glass door as it closes and locks, permitting electrical control of the glass door while maintaining security and architectural aesthetics.

Options

LMS – Latch Monitor Switch

Highlights

- No preparation required for glass doors
- Shock-absorbing action
- Non-handed (reversible)
- 3-year limited warranty

Applications

- Commercial Centers
- Industrial Buildings
- Educational Facilities
- Health Care Facilities
- Retail Outlets
- Office Complexes

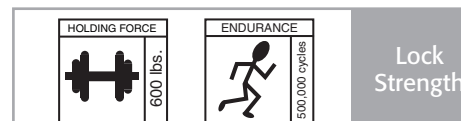
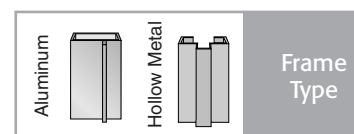

Note: Cushion-Lok™ Glass Door Locks are available by special order only. Please allow 12 weeks for delivery



In or Out...we make it Easy!®

CUSHION-LOK™ FOR TEMPERED GLASS DOORS WITH ALUMINUM OR HOLLOW METAL FRAMES

Model 3371 may be used with single or pairs of Tempered Glass Doors, with or without sidelights, transom panels or aluminum rails, where aluminum or hollow metal frames are specified.

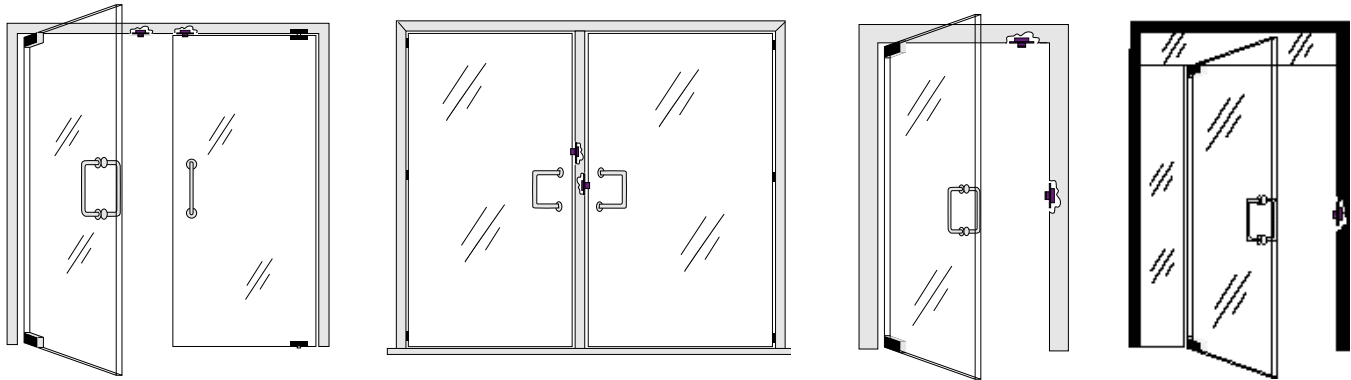

Specifications							
Model	Mode	Voltage	Current	Duty	Sound	Amps	Ohms
3371	Fail Unlocked	12V	DC	Continuous	Silent	0.21	58
3371	Fail Unlocked	24V	DC	Continuous	Silent	0.11	230

Fail Unlocked = Fail Safe = PL; DC = Direct Current; Intermittent Duty = Energized less than 1 min.; Continuous Duty = Energized 1 min. or more

Profiles												
Measurement	A	B	C	D	E	F	G	H	J	K	L	M
Fractional, inches	6-5/16	15/16	1/8	1-23/32	2-9/32	5-3/4	9/32	15/32	1-7/32	13/16	4-1/32	15/32
Decimal, inches	6.299	0.945	0.118	1.732	2.283	5.748	0.276	0.472	1.232	0.827	4.028	0.461
Metric, mm	160.0	24.0	3.0	44.0	58.0	146.0	7.0	12.0	31.3	21.0	102.3	11.7

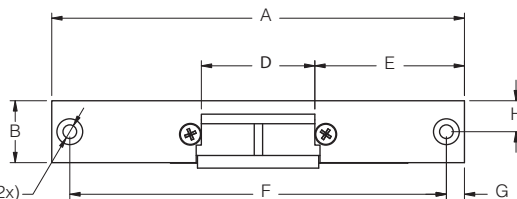
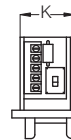
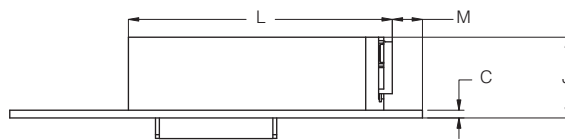

NOTE: Site dimensions are the installer's or frame manufacturer's responsibility. Horizontal centerlines are located by bolt location. Not to scale. Specifications are subject to change without notice.

RCI also offers a complete line of Electromagnetic Locks, Electric Strikes, Power Supplies, Switches, Keypads & Readers, Exit Devices, Systems & Door Hardware.