

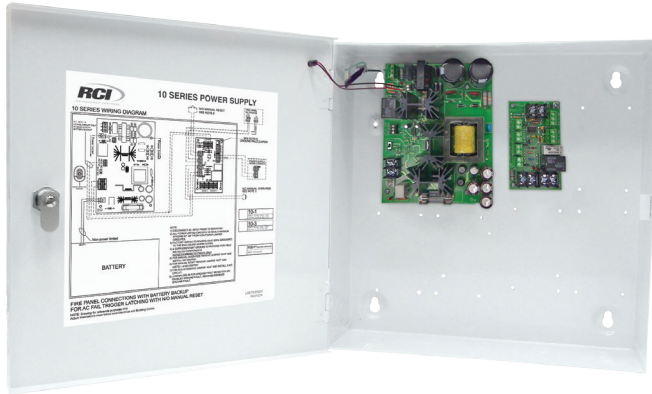

*In or Out... we make it Easy!®*



## 10 Series Power Supplies

**10-1 1.5 Amp**

**10-3 3 Amp**

### Dimensions

Box Size: 12.5"H x 12.5"W x 4"D  
(317.5mm x 317.5mm x 101.6mm)

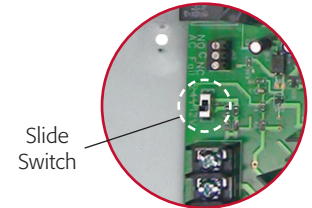

Slide Switch

Field Selectable  
12VDC and 24VDC  
output via slide switch

## Features & Benefits

- Field Selectable Voltage 12/24VDC
- Exceptional brownout protection
- Surge protected input
- The 10-1 models have Class 2 fused DC output
- AC and DC visual indication
- Precise battery regulation for lead acid batteries
- Backup batteries provide DC power on AC failure
- Form C relay to indicate AC failure

## Options & Accessories

- 4 and 8 Output Power Distribution Boards (Fused)
- PDM-8S has 8 selectable outputs of 3 various voltages
- Available with Fire Panel Interface
- 24-12VDC Converter Board
- 365 Day Timer
- 12-24VDC Converter Board

## Power Supplies

RCI's filtered and regulated 10 Series DC Power Supplies are designed with safety and reliability in mind; especially when it comes to electromagnetic locks. They incorporate many life safety options required to meet various code requirements such as: fire panel interface, instant unlock upon power failure and remote override reset capabilities for authorized personnel.

The Modular Distribution Board options make the 10 Series Power Supply the perfect solution when flexible power distribution is required. See Modular Distribution Boards descriptions for more information.



## Certifications

- Listed Access Control System Unit Power Supply
- Power Distribution Modules and 24V to 12V DC Converter are Listed Subassemblies

## Applications

- To power Access Control Systems
- To power Electric Locking Systems
- To power Electromagnetic Locking Systems

## Battery Backup Options

**BB4 .....** 4.5 Amp Hour Battery

**BB7.....** 7 Amp Hour Battery

Both available as 12VDC or 24VDC kits

# Specifications

10-1 & 10-3

10 Series



*In or Out... we make it Easy!®*

NOTE: Not to scale. Specifications are subject to change without notice.

Model No.	Description
10-1	1.5 Amp Power Supply <i>without</i> Fire Panel Disconnect
10-1-FPD	1.5 Amp Power Supply <i>with</i> Fire Panel Disconnect
10-3	3 Amp Power Supply <i>without</i> Fire Panel Disconnect
10-3-FPD	3 Amp Power Supply <i>with</i> Fire Panel Disconnect

Input
AC input 115VAC/60Hz
AC visual indicator

Output
Nominal Output Voltage 12VDC or 24VDC
- 1.5 and 3 Amps supply current at 12VDC
- 1 and 1.5 Amps supply current at 24VDC
- Thermally protected DC output
- AC Fail Relay
Visual indication

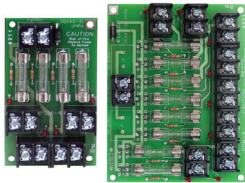

**PDM-4 & PDM-8**  
**Non-selectable 4 & 8 Output**  
**Distribution Board (Fused)**  
 PDM-4 and PDM-8 board distributes a single DC source into 4 or 8 outputs.  
 Max 2 Amps per output.

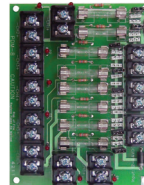

**PDM-8S**  
**Selectable 8 Output**  
**Distribution Board (Fused)**  
 PDM-8S board distributes up to three (3) DC sources into 8 outputs.  
 Max 2 Amps per output.



**PDD-FT**  
**Power Distribution Board**  
**with Fire Trigger**  
 PDD-FT board is a fire panel control interface. This board can be used to control DC output based on a fire alarm control panel.



**24-12CONV**  
**24-12 VDC**  
**Converter Board**  
 24-12 Converter Board will convert the output of a 24VDC power supply down to 12VDC. This board can be used to allow a user to have output voltages at 24VDC and 12VDC from the same single output power supply.  
 Max 1.5 Amps dependent on input.

Available Options	
PDM-4	Non-Selectable 4 Output Distribution Board (Fused)
PDM-8	Non-Selectable 8 Output Distribution Board (Fused)
PDM-8S	Selectable 8 Output Distribution Board (Fused)
PDD-FT	Power Distribution Devices with Fire Trigger to suit either model
24-12CONV	24-12 VDC Converter Board
12-24CONV	12-24 VDC Converter Board
TD365	365 Day Timer
BB12-4	4.5 Ahr Battery Backup (1)
BB12-7	7 Ahr Battery Backup (1)
BB24-4	4.5 Ahr Battery Backup (2)
BB24-7	7 Ahr Battery Backup (2)